

AMERICAN TECHNOLOGIES NETWORK CORP.



**JAVELIN**

**J68/ J125/ J125W/ J169W**

**Tactical Flashlights**



*u s e r ' s g u i d e*

**Important Export Restrictions!** Commodities, products, technologies and services contained in this manual are subject to one or more of the export control laws and regulations of the US BIS-Department of Commerce, Export Administration Regulations. It is unlawful and strictly prohibited to export, or attempt to export or otherwise transfer or sell any hardware or technical data or furnish any service to any foreign person, whether abroad or in the United States, for which a license or written approval of the U.S. Government is required, without first obtaining the required license or written approval from the Department of the U.S. Government having jurisdiction. Diversion contrary to U.S. law is prohibited.

## SPECIFICATIONS

	J68	J125	J125W	J169W
Material:	Aircraft grade 6061 aluminium			
Power in lumens:	68	125	200	220
Lamp type:	LED	Halogen	LED	LED
Battery type:	3V CR 123A Lithium (x2 J68/J125; x3 J169W)			
Length:	147 mm	164 mm	145 mm	215 mm
Weight:	140 g	180 g	230 g	320 g
Color:	Black			
Mount:	-	-	Picatinny/ standard weaver	Picatinny/ standard weaver

\* ATN reserves the right to change the above specifications at any time without notice

## APPLICATION

Javelin flashlights are intended for use as high intensity, heavy duty, portable light sources. Use of the flashlights for any purpose other than light sources is specifically discouraged by the manufacturer.

## MOUNTING (J125W, J169W)

Slightly loosen the fixing screws on the built in a mounting system of the device.

Place the device on the dovetail mount of a fire arm, making sure that the mount aligns with the receptor attachment of the screw grooves and tighten the fixing screws.

### Remote control:

Place the remote control on the weapon, suiting your shooting style best and grip. Fix the remote control in this position with a montage strap.

## OPERATING INSTRUCTION

There are two ways to activate the light from J68/ J125. The tail cap switch of the flashlight can be activated by rotating the tail cap in a clockwise direction for a constant "ON" setting or by pressing on the push button for temporary light.

The models J125W/ J169W can be activated for temporary light by pressing the button of remote control.

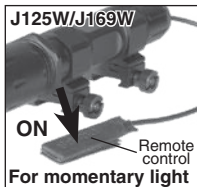

### J68 /J125 “push button/momentary on” lockout procedure:

1. From the constant “ON” position, back the tail cap “OFF” until the light goes out and turn the tail cap one full turn counterclockwise from this position.
2. Push button switch is now locked out.
3. Restore push button function, rotate the tail cap one full turn clockwise.

## BATTERY

1. Remove the tail cap unscrewing it until it is free of the body.
2. Install the batteries in the body, observing proper battery polarity.
3. Install the tail cap back on the body, turning it until the light comes on. Then back off 1/2 to 1 turn until the light turns off.

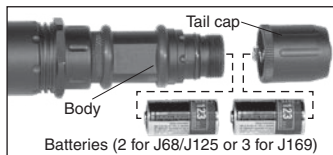

## CHANGING THE LAMP (ONLY J125 /J125W AND J169W)

1. Remove the bezel from the body by holding the body and rotating the bezel counterclockwise (as viewed from the front of the light) until it is free of the body.
2. Remove the lamp and replace with the desired lamp.

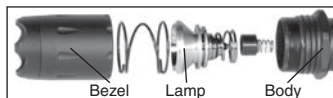

**NOTE: Avoid touching the inside of the lamp envelope or reflector as this will degrade the performance of your surefire light.**

3. Install the bezel back on to the body.

## GENERAL MAINTENANCE

- O-ring area between tail cap and tail button must remain clean and free of particles to maintain proper function.
- The glass lens is replaceable by unscrewing the fixative ring from the bezel.
- Battery must remain free to move back and forth inside barrel to maintain proper switching function.
- Keep flashlight clean at all times. An abrasive pencil eraser works well to clean the contacts.

## SAFETY

**WARNING:** Never leave your Javelin with its face against any surface while in operation. The resultant heat build-up may cause a fire.

Do not try to repair the unit yourself. Take it to a qualified service facility or return it to the factory.

Flashlights have modular bezel, which can be used as a defensive tool in emergencies or a glass breaker. Do not use it as an attacking weapon!

## **1 YEAR PRODUCT WARRANTY**

This product is guaranteed to be free from manufacturing defects in material and workmanship under normal use for a period of 1 (one) years from the date of purchase. In the event a defect that is covered by the foregoing warranty occurs during the applicable period stated above, ATN, at its option, will either repair or replace the product, and such action on the part of ATN shall be the full extent of ATN's liability, and the Customer's sole and exclusive remedy. This warranty does not cover a product (a) used in other than its normal and customary manner; (b) subjected to misuse; (c) subjected to alterations, modifications or repairs by the Customer of by any party other than ATN without prior written consent of ATN; (d) special order or "close-out" merchandise or merchandise sold "as-is" by either ATN or the ATN dealer; or (e) merchandise that has been discontinued by the manufacturer and either parts or replacement units are not available due to reasons beyond the control of ATN. ATN shall not be responsible for any defects or damage that in ATN's opinion is a result from the mishandling, abuse, misuse, improper storage or improper operation, including use in conjunction with equipment which is electrically or mechanically incompatible with or of inferior quality to the product, as well as failure to maintain the environmental conditions specified by the manufacturer. This warranty is extended only to the original purchaser. Any breach of this warranty shall be waived unless the customer notifies ATN at the address noted below within the applicable warranty period.

The customer understands and agrees that except for the foregoing warranty, no other warranties written or oral, statutory, expressed or implied, including any implied warranty of merchantability or fitness for a particular purpose, shall apply to the product. All such implied warranties are hereby and expressly disclaimed.

## **LIMITATION OF LIABILITY**

ATN will not be liable for any claims, actions, suits, proceedings, costs, expenses, damages or liabilities arising out of the use of this product. Operation and use of the product are the sole responsibility of the Customer. ATN's sole undertaking is limited to providing the products and services outlined herein in accordance with the terms and conditions of this Agreement. The provision of products sold and services performed by ATN to the Customer shall not be interpreted, construed, or regarded, either expressly or implied, as being for the benefit of or creating any obligation toward any third party of legal entity outside ATN and the Customer; ATN's obligations under this Agreement extend solely to the Customer. **ATN's liability hereunder for damages, regardless of the form or action, shall not exceed the fees or other charges paid to ATN by the customer or customer's dealer. ATN shall not, in any event, be liable for special, indirect, incidental, or consequential damages, including, but not limited to, lost income, lost revenue, or lost profit, whether such damages were foreseeable or not at the time of purchase, and whether or not such damages arise out of a breach of warranty, a breach of agreement, negligence, strict liability or any other theory of liability.**

## **PRODUCT WARRANTY REGISTRATION**

In order to validate the warranty on your product, ATN must receive a completed Product Warranty Registration Card for each unit or complete warranty registration on our website at [www.atncorp.com](http://www.atncorp.com). Please complete the included form and immediately mail it to our Service Center: ATN Corporation, 1341 San Mateo Avenue, South San Francisco, CA 94080.

## **OBTAINING WARRANTY SERVICE**

To obtain warranty service on your unit, End-user must notify ATN service department by calling 800-910-2862 or 650-989-5100 or via e-mail [service@atncorp.com](mailto:service@atncorp.com) to receive a Return Merchandise Authorization number (RMA). When returning please take or send the product, postage paid, with a copy of your sales receipt to our service center, ATN Corporation at the address noted above. All merchandise must be fully insured with the correct postage; ATN will not be responsible for improper postage or, missing or damaged merchandise during shipment. When sending product back, please clearly mark the RMA# on the outside of the shipping box. Please include a letter that indicates your RMA#, Name, Return Address, reason for service return, Contact information such as valid telephone numbers and/or e-mail address and proof of purchases that will help us to establish the valid start date of the warranty. Product merchandise returns that do not have an RMA listed may be refused or a significant delay in processing may occur. Estimated Warranty service time is 10-20 business days. End-user/customer is responsible for postage to ATN for warranty service. ATN will cover return postage/shipping after warranty repair to end-user/customer only if product is covered by aforementioned warranty. ATN will return product after warranty service by domestic UPS ground and/or domestic mail. Any other requested or required shipping method the postage/shipping fee will be the responsibility of the end-user/customer.

For customer service and technical support, please contact

### **American Technologies Network Corp.**

1341 San Mateo Avenue, South San Francisco, CA 94080  
phone: 800-910-2862, 650-989-5100; fax: 650-875-0129

[www.atncorp.com](http://www.atncorp.com)